

JL2-3000



General Features

- > High corrosion resistant performance: Pb-Ca multi-alloy grid
- > Long life
- > Excellent charge acceptance ability
- > Excellent deep cycle discharge capability
- > Strong high and low temperature performance
- > Precision sealing technology



Dimension: 712(L)×353(W)×341(H)×382(TH) Unit: mm

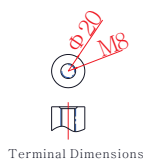
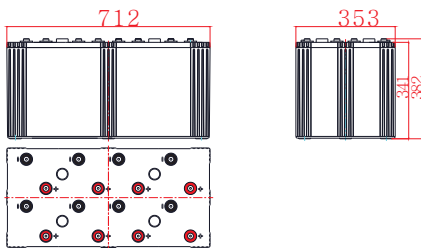

Applications

- > Telecommunications system
- > Power systems
- > UPS/EPS
- > Auto control system
- > Solar/wind generating storage cyclic
- > Other general purpose

Specification

Nominal Voltage	2V	
Nominal Capacity	3000Ah	
Design life	15 years	
Terminal	M8	
Approx. Weight	Approx 192kg (423lbs)	
Container Material	ABS	
Rated Capacity	3000Ah	10Hour Rate (300A to 1.80V)
	2304Ah	3Hour Rate (768A to 1.80V)
	1727Ah	1Hour Rate (1727A to 1.75V)
Internal resistance	Full charged at 25°C: 0.11 mΩ	
Max. Discharge Current	30000A(5S)	
Operating Temperature	Discharge: -20 ~50°C(-4~ 122°F)	
	Charge: -20 ~50°C(-4~ 122°F)	
	Storage: -20 ~50°C(-4~ 122°F)	
Charge current:	Max. 600.0A ; Recom.300.0A	
Charge Method (25 °C)	Float Charge:2.23-2.27V,recom.2.25V(-3mV/ °C)	
	Equalize charge:2.30-2.35V,recom.2.35V(-4mV/ °C)	
	Cycle charge:2.40-2.50V,recom.2.40V(-5mV/ °C)	
Self discharge	3% of capacity declined per month at 25°C	

Constant Current Discharge Characteristics Unit: A (25°C, 77°F)

FV/Time	15min	30min	1h	2h	3h	5h	8h	10h	20h
1.60V	4313	3194	1999	1179	865	582	395	325	174
1.65V	4021	2997	1897	1151	843	568	389	322	172
1.70V	3770	2814	1812	1109	819	563	383	317	170
1.75V	3569	2615	1727	1070	794	547	379	312	167
1.80V	3365	2447	1618	1012	769	534	371	300	161
1.85V	2984	2182	1472	942	730	516	361	297	159

Constant Power Discharge Characteristics Unit: W/cell (25°C, 77°F)

FV/Time	15min	30min	1h	2h	3h	5h	8h	10h	20h
1.60V	7332	5838	4120	2475	1816	1230	833	687	367
1.65V	7036	5611	3807	2396	1750	1191	820	672	359
1.70V	6786	5384	3625	2307	1684	1169	802	652	349
1.75V	6531	5200	3484	2223	1619	1139	772	642	344
1.80V	6225	5017	3281	2119	1564	1106	752	632	338
1.85V	5670	4461	3034	1938	1482	1058	728	608	325

JL2-3000

Discharge characteristic

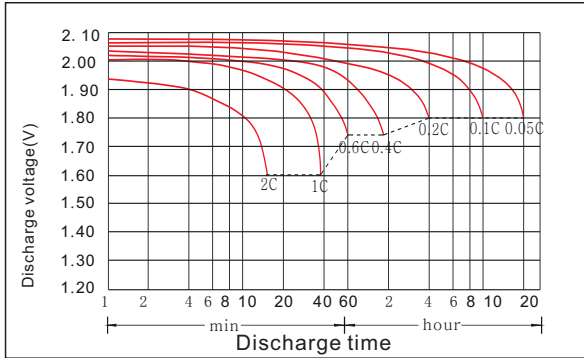

Charging characteristic

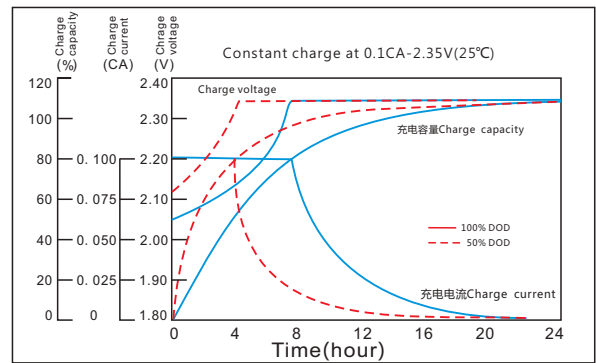

The effect of temperature on capacity

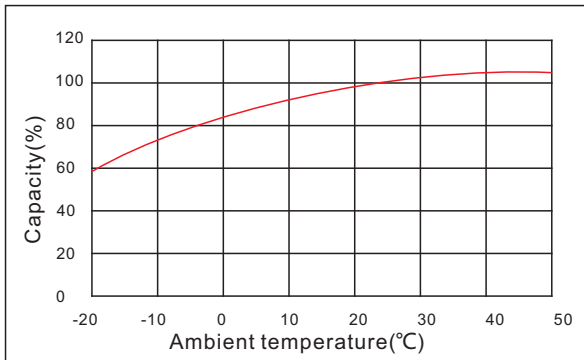

The effect of discharge depth on cycle life

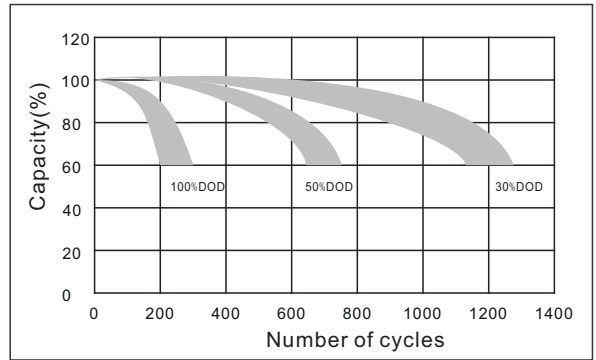

Curves of self-discharge



The effect of temperature on float life

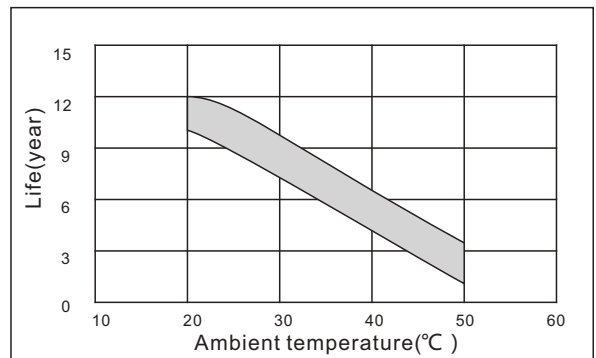

www.kijo.com.cn info@kijo.com.cn

Jiangxi Jingjiu Power Science&Technology Co. Ltd.
Add: 1388 Fushan No.1 Street, Xiaolan Economic Development Zone, Nanchang City, Jiangxi Province, China.

+86-791-85982779 +86-791-85989842

Jiangxi Jingjiu Power (Jiujiang) Co. Ltd.
Add: Xiwang Rd, Aicheng Industrial Park, Yongxiu Country, Jiujiang City, Jiangxi Province, China.

