

JL2-300



JL series lead-acid battery

General Features

- > High corrosion resistant performance: Pb-Ca multi-alloy grid
- > Long life
- > Excellent charge acceptance ability
- > Excellent deep cycle discharge capability
- > Strong high and low temperature performance
- > Precision sealing technology



Dimension: 171(L)×151(W)×330(H)×366(TH) Unit: mm

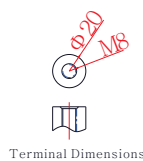
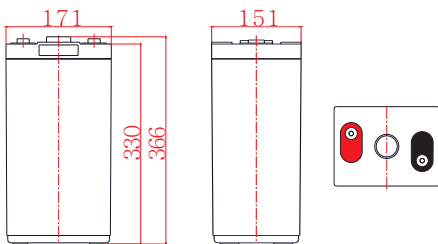

Applications

- > Telecommunications system
- > Power systems
- > UPS/EPS
- > Auto control system
- > Solar/wind generating storage cyclic
- > Other general purpose

Specification

Nominal Voltage	2V	
Nominal Capacity	300Ah	
Design life	15 years	
Terminal	M8	
Approx. Weight	Approx 18.0kg (39.7lbs)	
Container Material	ABS	
Rated Capacity	300Ah	10Hour Rate (30.0A to 1.80V)
	231Ah	3Hour Rate (76.9A to 1.80V)
	173Ah	1Hour Rate (173A to 1.75V)
Internal resistance	Full charged at 25°C: 0.55 mΩ	
Max. Discharge Current	3000A(5S)	
Operating Temperature	Discharge: -20 ~50°C(-4~ 122°F)	
	Charge: -20 ~50°C(-4~ 122°F)	
	Storage: -20 ~50°C(-4~ 122°F)	
Charge current:	Max. 60A ; Recom.30.0A	
Charge Method (25 °C)	Float Charge:2.23-2.27V,recom.2.25V(-3mV/ °C)	
	Equalize charge:2.30-2.35V,recom.2.35V(-4mV/ °C)	
	Cycle charge:2.40-2.50V,recom.2.40V(-5mV/ °C)	
Self discharge	3% of capacity declined per month at 25°C	

Constant Current Discharge Characteristics Unit: A (25°C, 77°F)

FV/Time	15min	30min	1h	2h	3h	5h	8h	10h	20h
1.60V	431	319	200	118	86.5	58.2	39.5	32.5	17.4
1.65V	402	300	190	115	84.3	56.8	38.9	32.2	17.2
1.70V	377	281	181	111	81.9	56.3	38.3	31.7	17.0
1.75V	357	262	173	107	79.4	54.7	37.9	31.2	16.7
1.80V	337	245	162	101	76.9	53.4	37.1	30.0	16.1
1.85V	298	218	147	94.2	73.0	51.6	36.1	29.7	15.9

Constant Power Discharge Characteristics Unit: W/cell (25°C, 77°F)

FV/Time	15min	30min	1h	2h	3h	5h	8h	10h	20h
1.60V	733	584	412	247	182	123	83.3	68.7	36.7
1.65V	704	561	381	240	175	119	82.0	67.2	35.9
1.70V	679	538	363	231	168	117	80.2	65.2	34.9
1.75V	653	520	348	222	162	114	77.2	64.2	34.4
1.80V	623	502	328	212	156	111	75.2	63.2	33.8
1.85V	567	446	303	194	148	106	72.8	60.8	32.5

Discharge characteristic

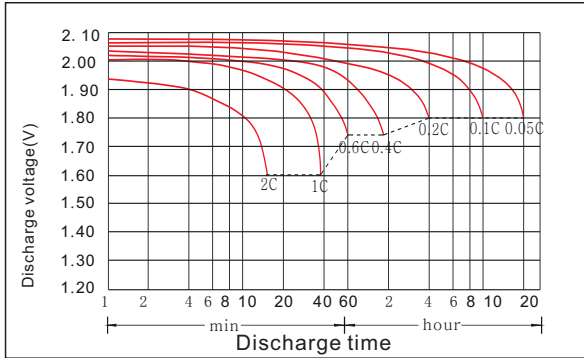

Charging characteristic

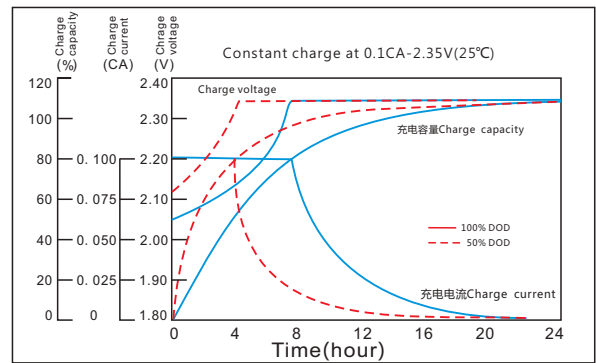

The effect of temperature on capacity

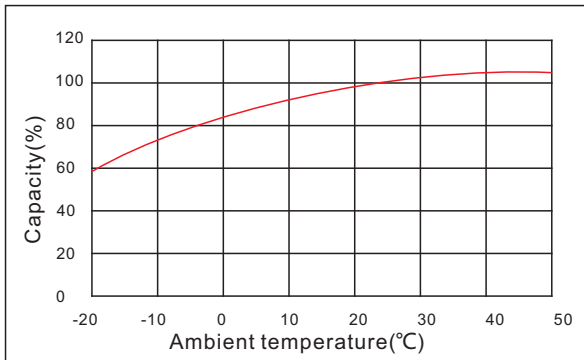

The effect of discharge depth on cycle life

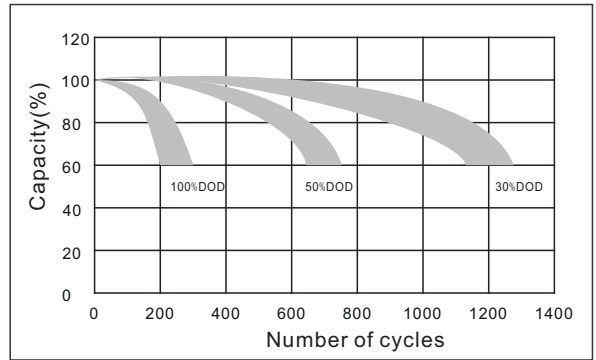

Curves of self-discharge



The effect of temperature on float life

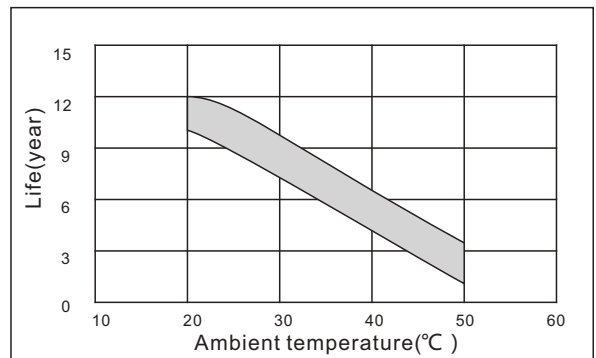

www.kijo.com.cn info@kijo.com.cn

Jiangxi Jingjiu Power Science&Technology Co. Ltd.
Add: 1388 Fushan No.1 Street, Xiaolan Economic Development Zone, Nanchang City, Jiangxi Province, China.

+86-791-85982779 +86-791-85989842

Jiangxi Jingjiu Power (Jiujiang) Co. Ltd.
Add: Xiwang Rd, Aicheng Industrial Park, Yongxiu Country, Jiujiang City, Jiangxi Province, China.

