

JL2-250



General Features

- > High corrosion resistant performance: Pb-Ca multi-alloy grid
- > Long life
- > Excellent charge acceptance ability
- > Excellent deep cycle discharge capability
- > Strong high and low temperature performance
- > Precision sealing technology



Dimension: 171(L)×151(W)×330(H)×366(TH) Unit: mm

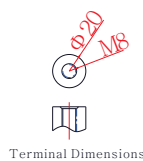
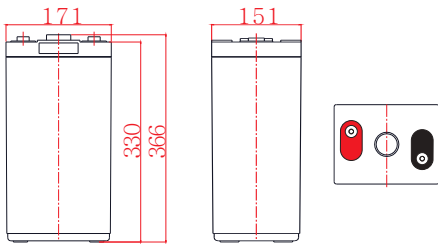

Terminal Dimensions

Applications

- > Telecommunications system
- > Power systems
- > UPS/EPS
- > Auto control system
- > Solar/wind generating storage cyclic
- > Other general purpose

Specification

Nominal Voltage	2V		
Nominal Capacity	250Ah		
Design life	15 years		
Terminal	M8		
Approx. Weight	Approx 16.0kg (35.3lbs)		
Container Material	ABS		
Rated Capacity	250Ah	10Hour Rate	(25.0A to 1.80V)
	192.3Ah	3Hour Rate	(64.1A to 1.80V)
	144Ah	1Hour Rate	(144A to 1.75V)
Internal resistance	Full charged at 25°C: 0.55 mΩ		
Max. Discharge Current	2500A(5S)		
Operating Temperature	Discharge: -20 ~50°C(-4~ 122°F)		
	Charge: -20 ~50°C(-4~ 122°F)		
	Storage: -20 ~50°C(-4~ 122°F)		
Charge current:	Max. 30A ; Recom.25.0A		
Charge Method (25 °C)	Float Charge:2.23-2.27V,recom.2.25V(-3mV/ °C)		
	Equalize charge:2.30-2.35V,recom.2.35V(-4mV/ °C)		
	Cycle charge:2.40-2.50V,recom.2.40V(-5mV/ °C)		
Self discharge	3% of capacity declined per month at 25°C		

Constant Current Discharge Characteristics Unit: A (25°C, 77°F)

FV/Time	15min	30min	1h	2h	3h	5h	8h	10h	20h
1.60V	359	266	167	98.3	72.1	48.5	32.9	27.1	14.5
1.65V	335	250	158	95.8	70.3	47.3	32.4	26.8	14.3
1.70V	314	234	151	92.5	68.3	46.9	31.9	26.4	14.2
1.75V	298	218	144	89.2	66.2	45.6	31.6	26.0	13.9
1.80V	281	204	135	84.2	64.1	44.5	30.9	25.0	13.4
1.85V	248	182	123	78.5	60.8	43.0	30.1	24.8	13.3

Constant Power Discharge Characteristics Unit: W/cell (25°C, 77°F)

FV/Time	15min	30min	1h	2h	3h	5h	8h	10h	20h
1.60V	611	487	343	206	152	103	69.4	57.3	30.6
1.65V	587	468	318	200	146	99.2	68.3	56.0	29.9
1.70V	566	448	303	193	140	97.5	66.8	54.3	29.1
1.75V	544	433	290	185	135	95.0	64.3	53.5	28.7
1.80V	519	418	273	177	130	92.5	62.7	52.7	28.2
1.85V	473	372	253	162	123	88.3	60.7	50.7	27.1

Discharge characteristic

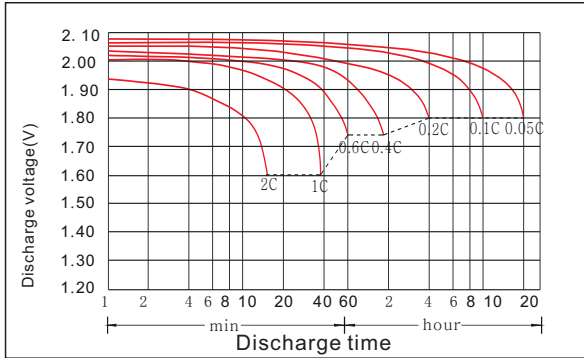

Charging characteristic

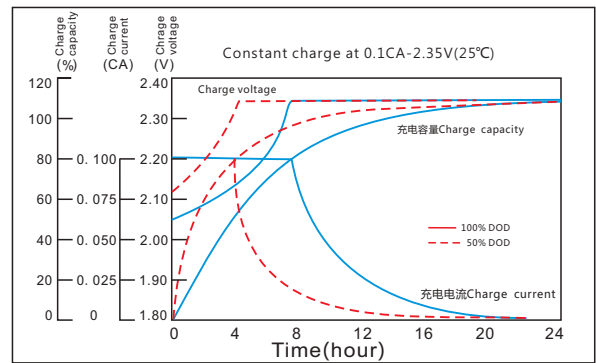

The effect of temperature on capacity

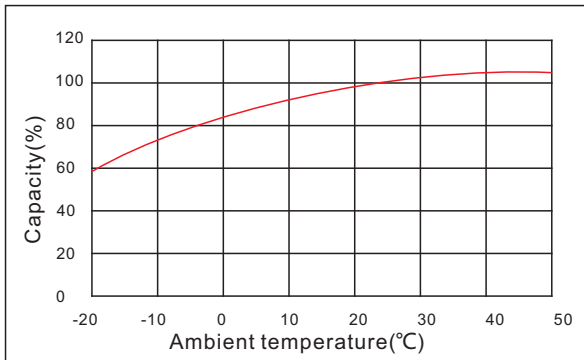

The effect of discharge depth on cycle life

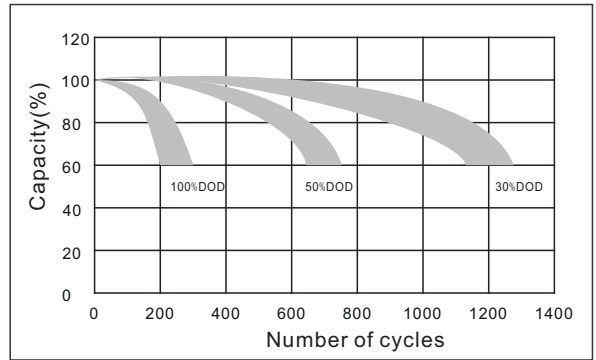

Curves of self-discharge



The effect of temperature on float life

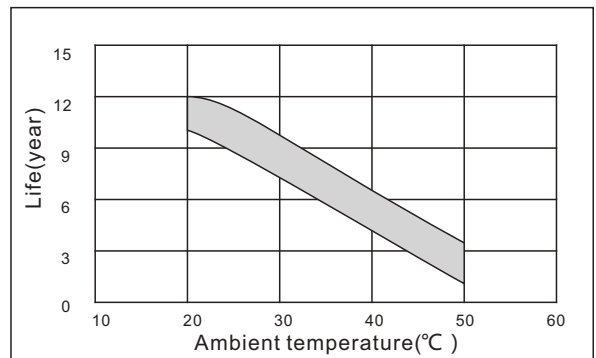

www.kijo.com.cn info@kijo.com.cn

Jiangxi Jingjiu Power Science&Technology Co. Ltd.
Add: 1388 Fushan No.1 Street, Xiaolan Economic Development Zone, Nanchang City, Jiangxi Province, China.

+86-791-85982779 +86-791-85989842

Jiangxi Jingjiu Power (Jiujiang) Co. Ltd.
Add: Xiwang Rd, Aicheng Industrial Park, Yongxiu Country, Jiujiang City, Jiangxi Province, China.

