

# JL2-200



## JL series lead-acid battery

### Applications

- > Telecommunications system
- > Power systems
- > UPS/EPS
- > Auto control system
- > Solar/wind generating storage cyclic
- > Other general purpose

### Specification

Nominal Voltage	2V	
Nominal Capacity	200Ah	
Design life	15 years	
Terminal	M8	
Approx. Weight	Approx 12.8kg (28.2lbs)	
Container Material	ABS	
Rated Capacity	200Ah	10Hour Rate (20.0A to 1.80V)
	154Ah	3Hour Rate (51.3A to 1.80V)
	115Ah	1Hour Rate (115A to 1.75V)
Internal resistance	Full charged at 25°C: 0.68 mΩ	
Max. Discharge Current	2000A(5S)	
Operating Temperature	Discharge: -20 ~50°C(-4~ 122°F)	
	Charge: -20 ~50°C(-4~ 122°F)	
	Storage: -20 ~50°C(-4~ 122°F)	
Charge current:	Max. 40A ; Recom.20.0A	
Charge Method (25 °C)	Float Charge:2.23-2.27V,recom.2.25V(-3mV/ °C)	
	Equalize charge:2.30-2.35V,recom.2.35V(-4mV/ °C)	
	Cycle charge:2.40-2.50V,recom.2.40V(-5mV/ °C)	
Self discharge	3% of capacity declined per month at 25°C	

### General Features

- > High corrosion resistant performance: Pb-Ca multi-alloy grid
- > Long life
- > Excellent charge acceptance ability
- > Excellent deep cycle discharge capability
- > Strong high and low temperature performance
- > Precision sealing technology



Dimension: 171(L)×111(W)×330(H)×365(TH) Unit: mm

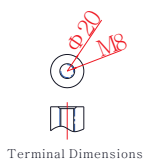
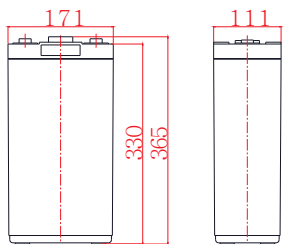

Terminal Dimensions

### Constant Current Discharge Characteristics Unit: A (25°C, 77°F)

FV/Time	15min	30min	1h	2h	3h	5h	8h	10h	20h
1.60V	288	213	133	78.6	57.7	38.8	26.4	21.7	11.6
1.65V	268	200	126	76.7	56.2	37.8	26.0	21.5	11.5
1.70V	251	188	121	73.9	54.6	37.5	25.6	21.1	11.3
1.75V	238	174	115	71.3	53.0	36.5	25.2	20.8	11.1
1.80V	224	163	108	67.4	51.3	35.6	24.8	20.0	10.7
1.85V	199	145	98.2	62.8	48.7	34.4	24.0	19.8	10.6

### Constant Power Discharge Characteristics Unit: W/cell (25°C, 77°F)

FV/Time	15min	30min	1h	2h	3h	5h	8h	10h	20h
1.60V	489	389	275	165	121	82.0	55.6	45.8	24.5
1.65V	469	374	254	160	117	79.4	54.6	44.8	24.0
1.70V	452	359	242	154	112	77.9	53.5	43.4	23.2
1.75V	435	347	232	148	108	75.9	51.5	42.8	22.9
1.80V	415	334	219	141	104	73.7	50.2	42.1	22.5
1.85V	378	297	202	129	99	70.5	48.5	40.5	21.7

Discharge characteristic

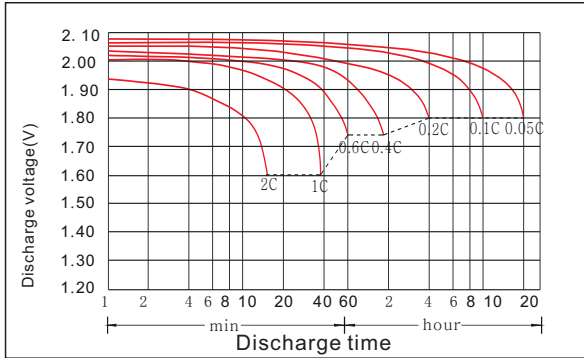

Charging characteristic

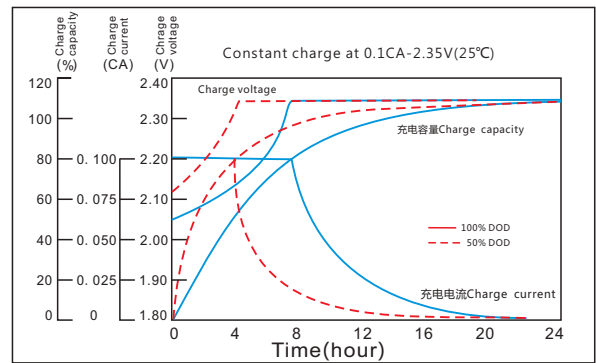

The effect of temperature on capacity

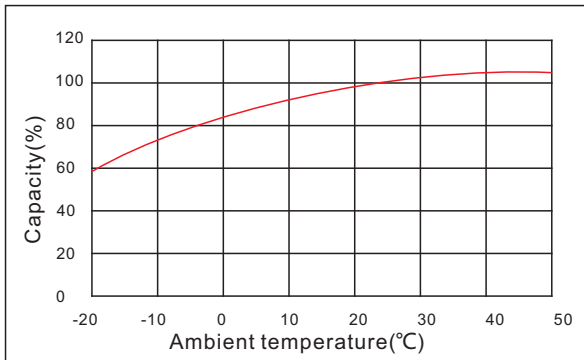

The effect of discharge depth on cycle life

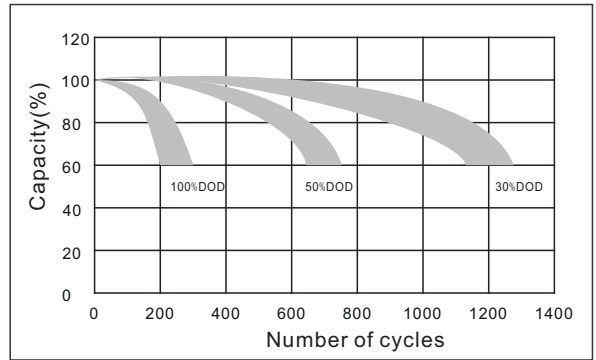

Curves of self-discharge



The effect of temperature on float life

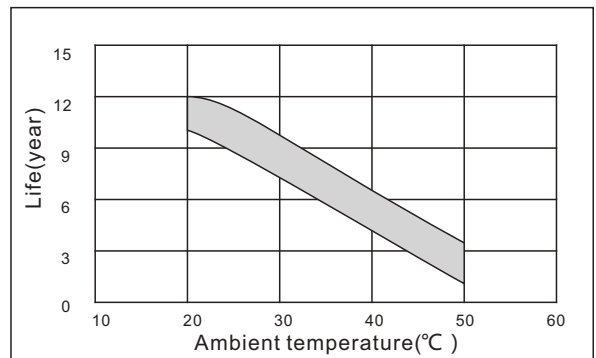

[www.kijo.com.cn](http://www.kijo.com.cn)    [info@kijo.com.cn](mailto:info@kijo.com.cn)

**Jiangxi Jingjiu Power Science&Technology Co. Ltd.**  
Add: 1388 Fushan No.1 Street, Xiaolan Economic Development Zone, Nanchang City, Jiangxi Province, China.

+86-791-85982779    +86-791-85989842

**Jiangxi Jingjiu Power ( Jiujiang ) Co. Ltd.**  
Add: Xiwang Rd, Aicheng Industrial Park, Yongxiu Country, Jiujiang City, Jiangxi Province, China.

