

# JL2-100



## JL series lead-acid battery

### Applications

- > Telecommunications system
- > Power systems
- > UPS/EPS
- > Auto control system
- > Solar/wind generating storage cyclic
- > Other general purpose

### Specification

|                        |  |                              |
|------------------------|--|------------------------------|
| Nominal Voltage        | 2V   |                              |
| Nominal Capacity       | 100Ah  |                              |
| Design life            | 10 years   |                              |
| Terminal               | M6   |                              |
| Approx. Weight         | Approx 6.00kg (13.2lbs)                          |                              |
| Container Material     | ABS  |                              |
| Rated Capacity         | 100Ah  | 10Hour Rate (10.0A to 1.80V) |
|                        | 75.3Ah   | 3Hour Rate (25.1A to 1.80V)  |
|                        | 56.4Ah   | 1Hour Rate (56.4A to 1.75V)  |
| Internal resistance    | Full charged at 25°C: 1.20 mΩ                    |                              |
| Max. Discharge Current | 1000A(5S)  |                              |
| Operating Temperature  | Discharge: -20 ~50°C(-4~ 122°F)                  |                              |
|                        | Charge: -20 ~50°C(-4~ 122°F)                     |                              |
|                        | Storage: -20 ~50°C(-4~ 122°F)                    |                              |
| Charge current:        | Max. 20A ; Recom.10.0A                           |                              |
| Charge Method (25 °C)  | Float Charge:2.23-2.27V,recom.2.25V(-3mV/ °C)    |                              |
|                        | Equalize charge:2.30-2.35V,recom.2.35V(-4mV/ °C) |                              |
|                        | Cycle charge:2.40-2.50V,recom.2.40V(-5mV/ °C)    |                              |
| Self discharge         | 3% of capacity declined per month at 25°C        |                              |

### General Features

- > High corrosion resistant performance: Pb-Ca multi-alloy grid
- > Long life
- > Excellent charge acceptance ability
- > Excellent deep cycle discharge capability
- > Strong high and low temperature performance
- > Precision sealing technology



Dimension: 171(L)×72(W)×206(H)×220(TH) Unit: mm

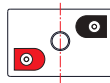
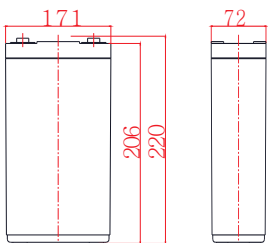

Terminal Dimensions

### Constant Current Discharge Characteristics Unit: A (25°C, 77°F)

| FV/Time | 15min | 30min | 1h   | 2h   | 3h   | 5h   | 8h   | 10h  | 20h  |
|---------|-------|-------|------|------|------|------|------|------|------|
| 1.60V   | 144   | 106   | 66.6 | 39.3 | 28.8 | 19.4 | 13.2 | 10.8 | 5.79 |
| 1.65V   | 134   | 100   | 63.2 | 38.4 | 28.1 | 18.9 | 13.0 | 10.7 | 5.74 |
| 1.70V   | 126   | 93.8  | 60.4 | 37.0 | 27.3 | 18.8 | 12.8 | 10.6 | 5.66 |
| 1.75V   | 119   | 87.2  | 57.6 | 35.7 | 26.5 | 18.2 | 12.6 | 10.4 | 5.57 |
| 1.80V   | 112   | 81.6  | 53.9 | 33.7 | 25.6 | 17.8 | 12.4 | 10.0 | 5.35 |
| 1.85V   | 100   | 72.7  | 49.1 | 31.4 | 24.3 | 17.2 | 12.0 | 9.90 | 5.30 |

### Constant Power Discharge Characteristics Unit: W/cell (25°C, 77°F)

| FV/Time | 15min | 30min | 1h  | 2h   | 3h   | 5h   | 8h   | 10h  | 20h  |
|---------|-------|-------|-----|------|------|------|------|------|------|
| 1.60V   | 244   | 195   | 137 | 82.5 | 60.5 | 41.0 | 27.8 | 22.9 | 12.2 |
| 1.65V   | 235   | 187   | 127 | 79.9 | 58.3 | 39.7 | 27.3 | 22.4 | 12.0 |
| 1.70V   | 226   | 179   | 121 | 76.9 | 56.1 | 39.0 | 26.7 | 21.7 | 11.6 |
| 1.75V   | 218   | 173   | 116 | 74.1 | 54.0 | 38.0 | 25.7 | 21.4 | 11.5 |
| 1.80V   | 208   | 167   | 109 | 70.6 | 52.1 | 36.9 | 25.1 | 21.1 | 11.3 |
| 1.85V   | 189   | 149   | 101 | 64.6 | 49.4 | 35.3 | 24.3 | 20.3 | 10.8 |

Discharge characteristic

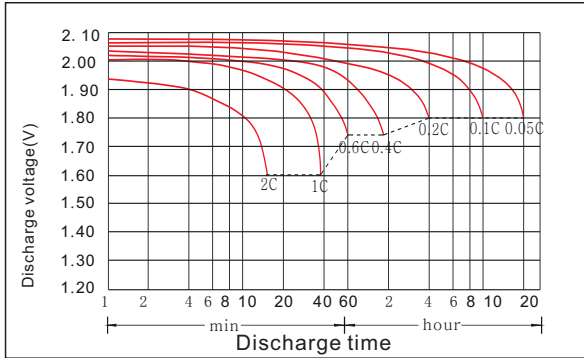

Charging characteristic

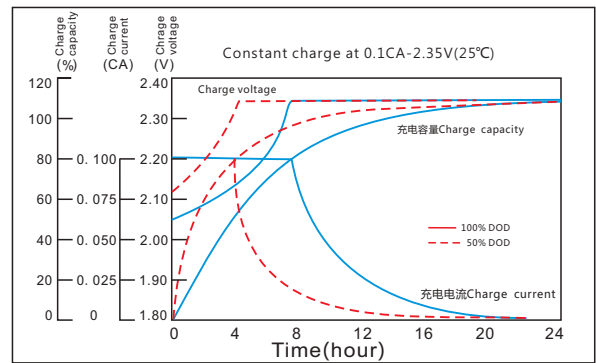

The effect of temperature on capacity

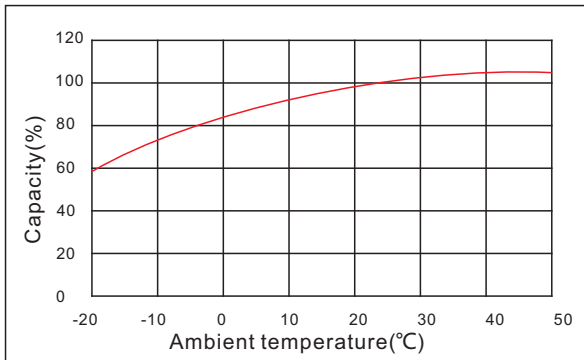

The effect of discharge depth on cycle life

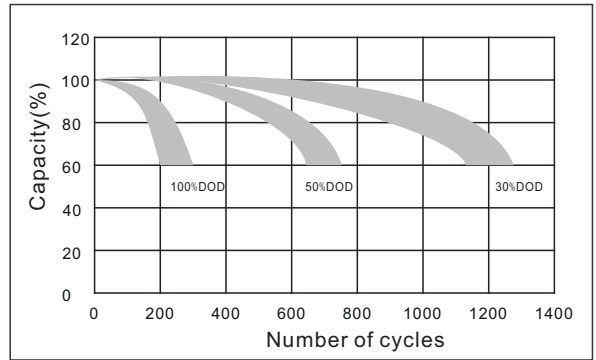

Curves of self-discharge



The effect of temperature on float life

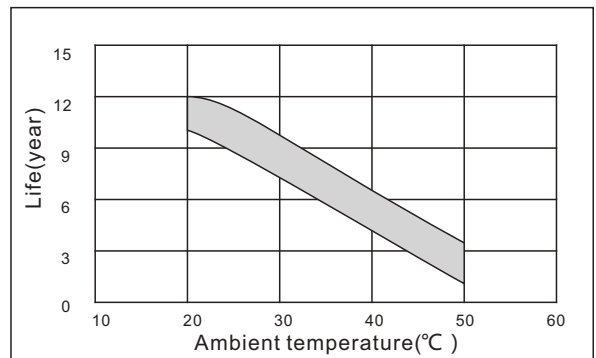

[www.kijo.com.cn](http://www.kijo.com.cn)    [info@kijo.com.cn](mailto:info@kijo.com.cn)

**Jiangxi Jingjiu Power Science&Technology Co. Ltd.**  
Add: 1388 Fushan No.1 Street, Xiaolan Economic Development Zone, Nanchang City, Jiangxi Province, China.

+86-791-85982779    +86-791-85989842

**Jiangxi Jingjiu Power ( Jiujiang ) Co. Ltd.**  
Add: Xiwang Rd, Aicheng Industrial Park, Yongxiu Country, Jiujiang City, Jiangxi Province, China.

